

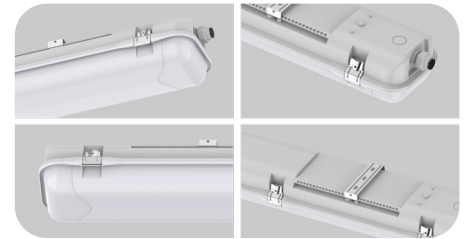

Xsara Eco



This tri-proof light is a sustainable alternative to fluorescent lamps, featuring high-lumen SMD LEDs, a high-transmittance shade, and a 120° wide beam angle for uniform light. Available in three sizes (600mm, 1200mm, 1500mm), it offers surface-mounted and pendant installation. The modular design allows easy replacement of LED parts and drivers, and plug-in options for microwave sensors and emergency packs.



Key features

- Clip-type design for LED part and driver part, tool free
- High lumen efficiency, 120lm/W
- IP65 IK08 protection level
- Interchangeable CCT(3000K+4000K+5700K) with DIP switch
- Surface mounted bracket can be moved 200mm, convenient for installation adjustment
- Installation ways: Surface mounted/ Pendant/ Splicing
- Internal flicker free driver

Technical Data

Model No.	XSARA ECO 20	XSARA ECO 50	XSARA ECO 60
Power Consumption (±5%)	20W	50W	60W
Input Voltage	AC220-240V		
Power Factor	>0.9		
LED Driver	Built-in		

Optic Information

LED Type	LED SMD		
Luminous Flux (±10%)	2500lm	6200lm	7500lm
Efficacy (5000K Ra70)	120lm/W		
Correlated Color Temperature	3CCT (3000K + 4000K + 5700K)		
Color Rendering Index	Ra80		
Beam Angle	120°		

Applications

- Warehouse
- Factory
- Industrial facility
- Workshop
- Parking lot

Lifespan and Warranty

Operating Temperature	-10°C to + 45°C
Lifetime of LED	50.000hrs
Warranty	3 Years

Dimensions and Mounting

Product Dimension	680x124x86 x327mm	1280x124x86 x837mm	1580x124x86 x1125mm
Luminaire Net Weight	1.03kg	1.88kg	2.28kg
Mounting Option	Surface mounting, Pendant mounting, Splice mounting		
Material	Polycarbonate (PC)		
Finish	Powder Coating		
Fixture Color	Grey		
IK Rating	IK08		
IP Rating	IP65		

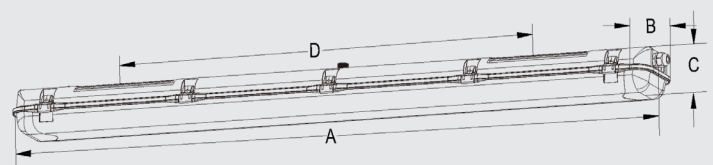

Type	A (mm)	B (mm)	C (mm)	D (mm)
Xsara Eco 20	680	124	86	327
Xsara Eco 50	1280	124	86	837
Xsara Eco 60	1580	124	86	1125