



Bublé

Featuring a traditional spherical design, this LED garden light draws inspiration from the earth, seamlessly integrating into natural surroundings. This luminaire offers various light source configurations, allowing users to select the appropriate application based on the desired lighting effect.

Key features

- Constructed with a die-cast aluminum body and a PC transparent diffuser
- Features optics with a PC lens for comfortable, uniform illumination and offers multiple light distribution options
- Equipped with high-quality LED chips, the driver supports 0-10V/DALI/programmed settings and includes surge protection up to 20KV
- Available in two configurations: modular or with a circular arrangement of light source modules
- Surface coated with UV-resistant pure polyester powder, providing corrosion resistance for over 1000 hours
- Compliant with EN 62471:2008, posing no photo-biological risk, including infrared, blue light, and UV radiation
- Utilizes smart technology for street lighting control, compatible with remote management systems
- All external screws are made of 304 stainless steel

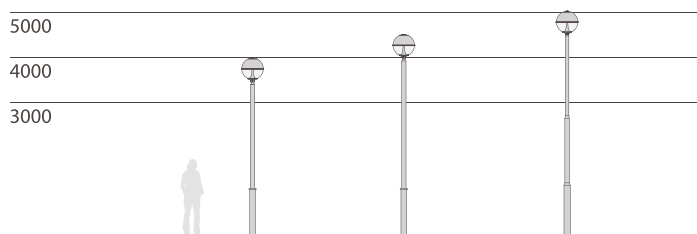

Applications

- Village streets
- Urban roadway lighting
- Park lighting
- Courtyard

Dimensions

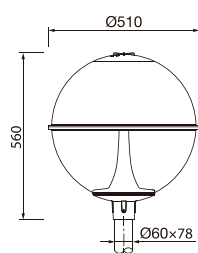



Photometry

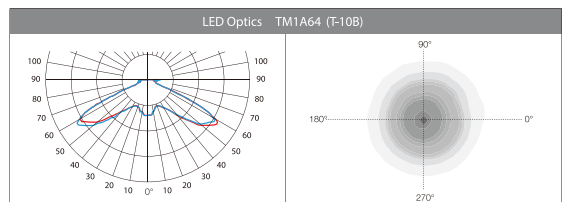
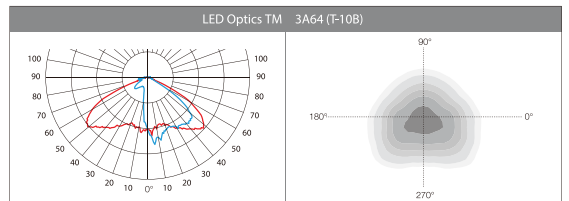
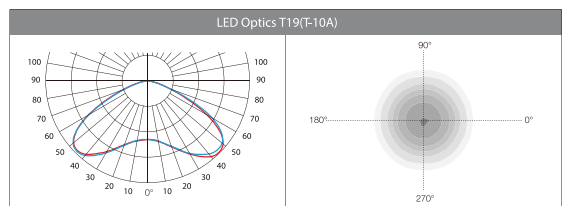

Technical Data

Code	Power	Lumen	Optics
Bublé-LED-40-2	40W	4500lm	T19
Bublé-LED-60-4	60W	7300lm	T19
Bublé-LED-75-4	75W	9000lm	T19
Bublé-LED-25-2	25W		T19
Bublé-LED-40-4	40W		T19