



# Sirius

Sirius is a new Solar LED street light with modern and slim design. Street light incorporates mono-crystalline photovoltaic solar panel, high efficiency of 200lm/W, which makes the product very versatile, with huge advantages for areas with low quality mains infrastructure or without mains infrastructure.

Made of Aluminum Alloy.



## Key features

- Good design, low weight, easier installation
- System efficiency up to 200lm/w with competitive price
- The Controller has built in Motion Sensor and timer dimming function
- LiFePO4 battery is with longer lifetime, charge for 8 hours which can work continuously for 3 days
- IP65 & IK08 double protection
- Monocrystalline photovoltaic panel with high conversion efficiency
- Adjustable angle
- Different mounting options

## Applications

- Village streets
- Urban roadway lighting
- Park lighting
- Courtyard

## Accessories



**±30° Pole Clamp Bracket**  
SPCC materials with outdoor powder coating.  
Can be also the wall mount bracket.



**Wall mount adapter**  
SPCC materials with outdoor powder coating.  
Code: SP-R03-05

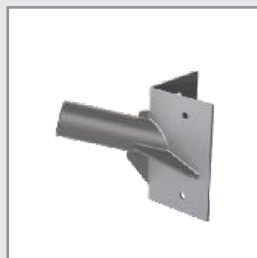

**Corner mount adapter**  
SPCC materials with outdoor powder coating.  
Code: SP-R19-02



**T shape pole mount adapter**  
SPCC materials, for dia.60 pole.  
Code: SP-R03-06



**L shape pole mount adapter**  
SPCC materials, for dia.60mm pole.  
Code: SP-R19-01

## Technical Data @4000K

<b>Model No.</b>	SIRIUS-10	SIRIUS-20	SIRIUS-30
<b>Power Consumption (±5%)</b>	10W	20W	30W
<b>Battery Capacity</b>	76Wh	156Wh	230Wh
<b>Battery</b>	LiFePO4 Battery		
<b>Solar Panels</b>	Mono-Crystalline Solar Panel		
<b>Solar Panel Wattage</b>	30W		
<b>Charging Time</b>	≥ 5.5Hrs		
<b>Operating time</b>	Full power >8 hours, Intelligent mode 3-4 days		
<b>Working mode</b>	1st 4Hours: 30% Brightness stand by, 100% brightness when movement is detected. 2nd 4hours: 20% brightness stand by, 60% brightness when movement is detected.		
<b>Control</b>	Timmer dimming/PIR sensor		

## Optic Information

<b>LED Type</b>	LED 2835		
<b>Luminous Flux (±10%)</b>	2000lm	4000lm	6000lm
<b>Efficacy(4000K Ra70)</b>	200lm/W		
<b>Correlated Color Temperature</b>	3000K (4000K, 5000K optional)		
<b>Color Rendering Index</b>	Ra70 (Ra80 optional)		
<b>Beam Angle</b>	R10801		

## Dimensions and Mounting

<b>Luminaire Net Weight</b>	5.0 kg	5.7 kg	6.3 kg
<b>Mounting Option</b>	Post top / Side Entry Pole clamp bracket / Wall Mount		
<b>Material</b>	Aluminum Alloy, Polycarbonate Optical Lens LiFePO4 Battery, Mono-Crystalline Solar Panel		
<b>Finish</b>	Powder Coating		
<b>Fixture Color</b>	Silver		
<b>EPA</b>	0.24m <sup>2</sup>		
<b>IK Rating</b>	IK08		
<b>IP Rating</b>	IP65		

## Lifespan and Warranty

<b>Operating Temperature</b>	-20°C to + 50°C
<b>Lifetime of LED</b>	64.000hrs-L80
<b>Warranty</b>	5 Years

## Photometry

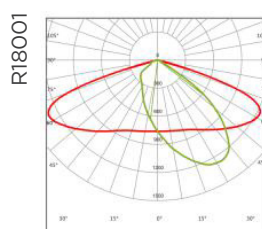

## Dimensions

Post Top Mount

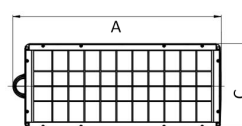

Side Entry Mount

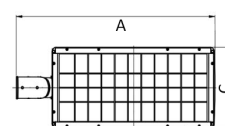

Pole Clamp  
Bracket Mount

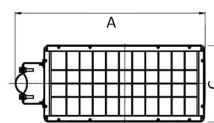

Wall Mount

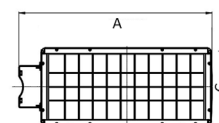

Type	A (mm)	B (mm)	C (mm)
<b>Post Top Mount</b>	703	250	301
<b>Side Entry Mount</b>	807	148	301
<b>Pole Clamp Bracket Mount</b>	781	131	301
<b>Wall Mount</b>	748	131	301

## Mounting Option

